

F Unit Chassis - Production started 2014

Chassis below is shown with a speaker and encloser (Only used with sound decoder)

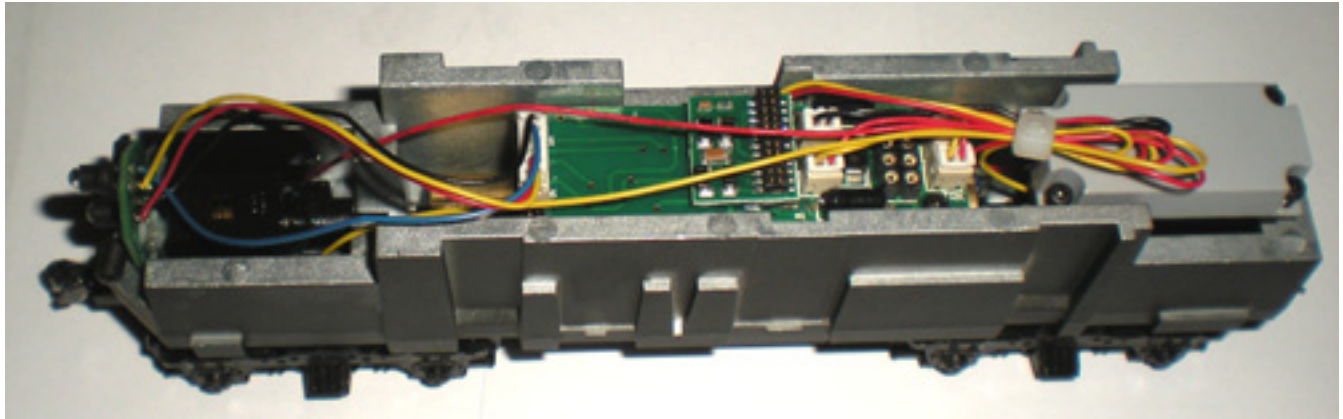

#691-41 Pair of Trucks with worm cover
sold by pair only

691-33
Universal Shaft
one piece

691-33
Universal Shaft
one piece

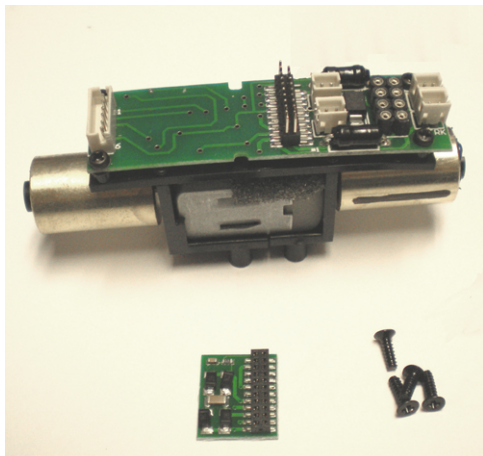
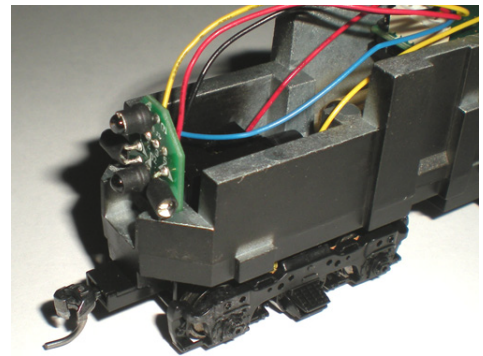

691-545 21 Pin Jumper Board
691-550 Motor with Flywheels
691-551 Main Circuit Board with 21 pin socket
691-12141 2mm x 6mm Flat head Screw

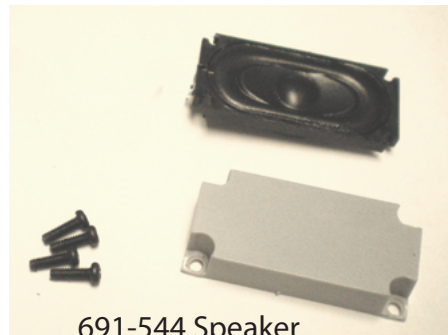

691-544 Speaker
691-549 Speaker Box
691-12140 Screws

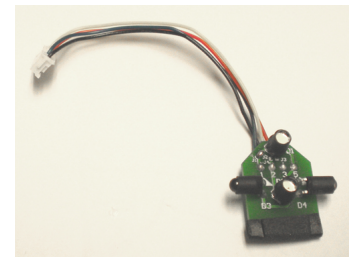

691-12139
Circuit board
Headlight and #board

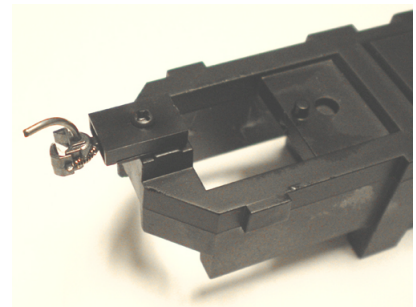

691-19 Coupler Box
691-20 Coupler Box cover
Use KD #5 coupler

When installing an 8 pin decoder remove the 21 pin jumper plug.

Future production will not have 8 pin sockets

**Bowser Executive Line
F Units**

Production started 2015

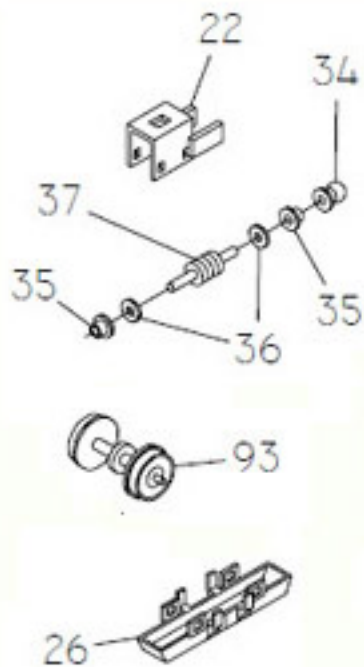
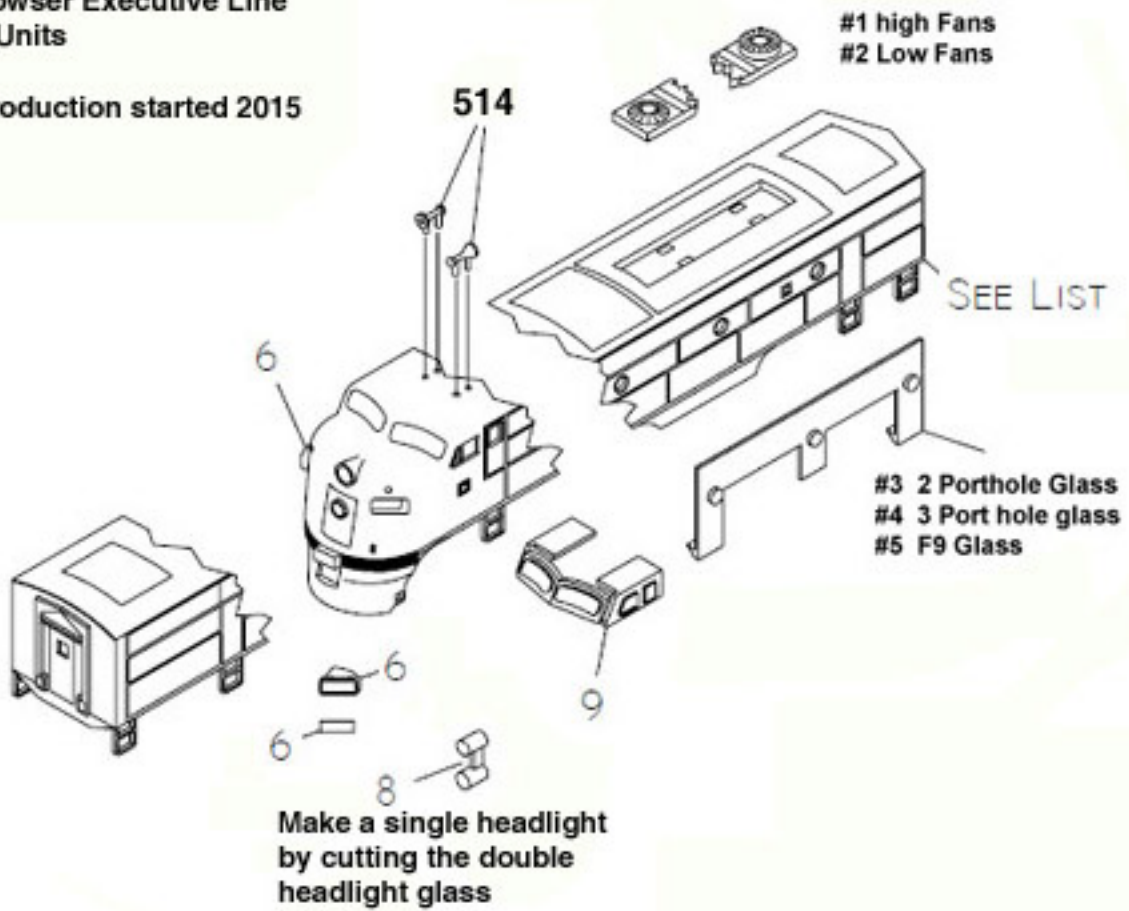

**Gear box sides and
individual gears are not
available**

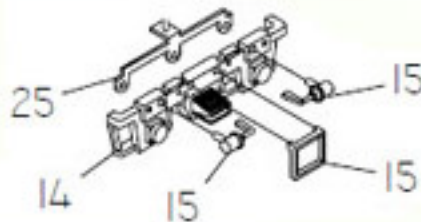

We do not have complete body shell kits

Part	Description
	Undecorated Body Shell, Specify:
5100-001	F3A Phase I Single Headlight
5100-002	F3B Phase I
5101-001	F3A Phase I Double Headlight
5102-001	F3A Phase I Single Headlight Non-Dynamic
5102-002	F3B Phase I Non-Dynamic
5103-001	F3A Phase I Double Headlight Non-Dynamic
5200-001	F3A Phase II Early Single Headlight
5200-002	F3B Phase II Early
5201-001	F3A Phase II Early Double Headlight
5202-001	F3A Phase II Early Single Headlight Non-Dynamic
5202-002	F3B Phase II Early Non-Dynamic
5203-001	F3A Phase II Early Double Headlight Non-Dynamic
5300-001	F3A Phase II Late Single Headlight
5300-002	F3B Phase II Late
5301-001	F3A Phase II Late Double Headlight
5302-001	F3A Phase II Late Single Headlight Non-Dynamic
5302-002	F3B Phase II Late Non-Dynamic
5303-001	F3A Phase II Late Double Headlight Non-Dynamic
5400-001	F3A Phase III Single Headlight
5400-002	F3B Phase III
5401-001	F3A Phase III Double Headlight
5402-001	F3A Phase III Single Headlight Non-Dynamic
5402-002	F3B Phase III Non-Dynamic
5403-001	F3A Phase III Double Headlight Non-Dynamic
5500-001	F3A Phase IV Single Headlight
5500-002	F3B Phase IV
5501-001	F3A Phase IV Double Headlight
5502-001	F3A Phase IV Single Headlight Non-Dynamic
5502-002	F3B Phase IV Non-Dynamic
5503-001	F3A Phase IV Double Headlight Non-Dynamic
5600-001	F7A Phase I Early Single Headlight
5600-002	F7B Phase I Early
5601-001	F7A Phase I Early Double Headlight
5502-001	F7A Phase I Early Single Headlight Non-Dynamic
5502-002	F7B Phase I Early Non-Dynamic
5503-001	F7A Phase I Early Double Headlight Non-Dynamic
5700-001	F7A Phase I Late Single Headlight
5700-002	F7B Phase I Late
5701-001	F7A Phase I Late Double Headlight
5800-001	F7A Phase II Single Headlight
5800-002	F7B Phase II
5801-001	F7A Phase II Double Headlight
5900-001	F9A Single Headlight
5900-002	F9B
5901-001	F9A Double Headlight